

# Multiturn Potentiometer

## ET3006 Cermet Trimming Potentiometer

ELECSOUND®

Rectangular/Multiturn/ Cermet/ Industrial/ Sealed

3 Terminal Styles

Rohs Compliant

### Electrical Characteristics

Standard Resistance range: 10Ω - 2MΩ

Resistance Tolerance: ±10% std.

Absolute Minimum Resistance: ≤1% or 2Ω

Contact Resistance Variation: ≤1% or 1Ω

Insulation Resistance : R1 ≥1,000 MegΩ

Withstand Voltage : 640VAC

Effective Travel: 22 turns normal

### Environmental Characteristics

Power Rating:(350V max.)0.75W@70°C, 0W@125°C

Temperature Range: -55°C to +125°C

Temperature Coefficient: ±100ppm/°C

Vibration: 10-500Hz, 0.75mm, 6Hour: ΔR≤±5%

Shock: 390m/s, 4000cycles, ΔR≤±3%

Electrical Endurance:0.75W@70°C,1000H,ΔR≤±5%

Rotational Life: 200Cycles,ΔR≤±3%

### Physical Characteristics

Starting Torque: ≤35mN·m

Flammability: UL94V-0

Marking: Resistance code, Model

Standard Packaging: 25pcs per tube

### How To Order

**ET3006 P - 1 - 103**

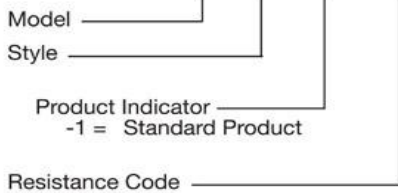

### Standard Resistance Table

Resistance (Ohms)	Resistance Code
10	100
20	200
50	500
100	101
200	201
500	501
1000	102
2000	202
5000	502
10000	103
20000	203
25000	253
50000	503
100000	104
200000	204
250000	254
500000	504
1000000	105
2000000	205



### ET3006 Common Dimension

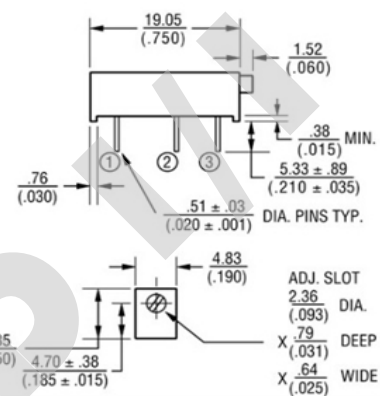

### Adjust Method

#### ET3006P

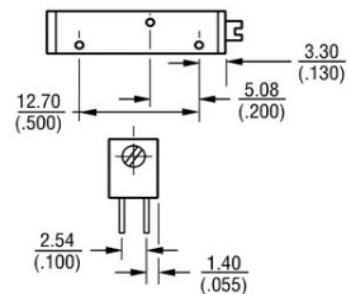

#### ET3006W

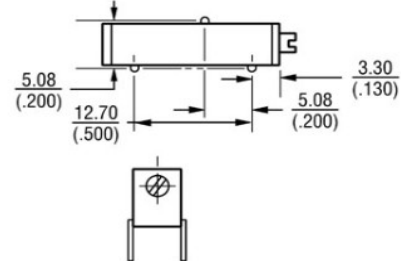

#### ET3006Y

